

FEATURES

- Modern, elegant & durable design
- Hygienic and ergonomic drying solution
- High velocity dryer, with drying time of 15-20 seconds
- Environmentally friendly - save 90% on power consumption
- Easy to mount and install
- Suitable for high-traffic commercial premises

INSTALLATION

PRE-INSTALLATION PRECAUTIONS

- Do not install the hand dryer in areas exposed to direct water contact, direct sunlight or heavy condensation.
- Install the hand dryer at least 15cm above the floor.
- Ensure that there is no mirror or protruding wall within 10cm of the right-hand side of the appliance.

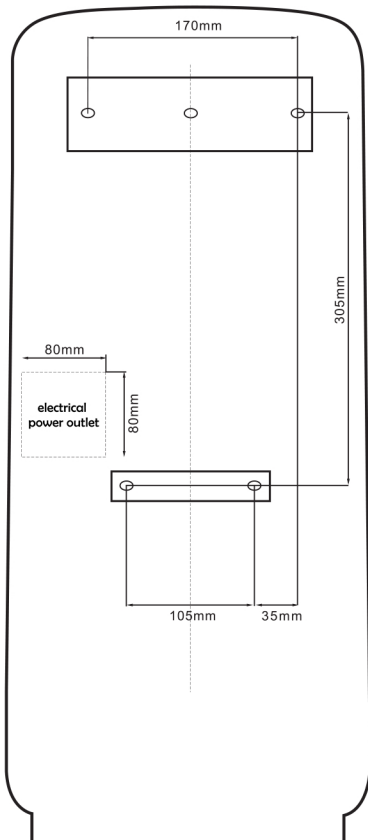

Fig. 1 drilling diagram

CLEANING

AIR FILTER

- Remove the filter horizontally using the handle as shown in Fig. 13.

Fig. 13

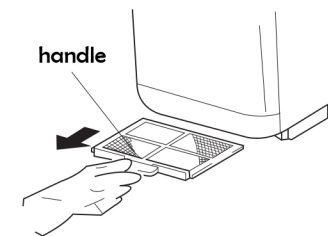

- Gently pat or vacuum the filter and replace, ensuring it is completely dry.

Fig. 14

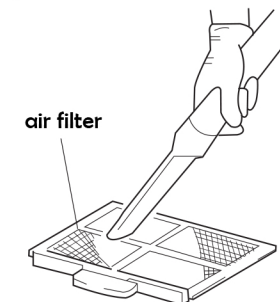

NOTICE

- ▲ Start switch **MUST** be activated after installation / power disconnect
- This dryer is to be installed by a qualified technician / professional
- Do not open the front panel or attempt to dismantle / clean the machine unless qualified
- Do not share switch spur connection with other appliances
- Turn off the main power supply before cleaning
- Dryer is not to be operated by children or persons with reduced physical or sensory capabilities unless supervised
- If the supply cord is damaged, it must be replaced by the manufacturer, service agent or similarly qualified persons

CLEANING

WATER CONTAINER

- Remove container and take off the cover.

Fig. 9



- Dispose of any water before the container becomes full. **NOTE:** this should be done at least once a week.

Fig. 10

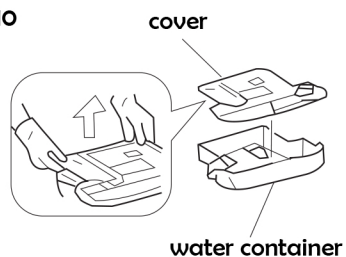

- Thoroughly clean the container and replace once completely dry.

Fig. 11

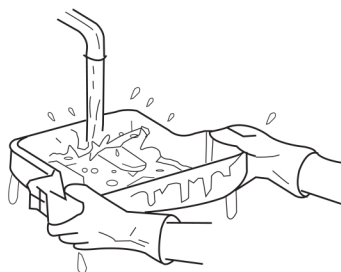

- Pour 200ml of fresh water into the drain of the dryer to prevent any blockages.

Fig. 12

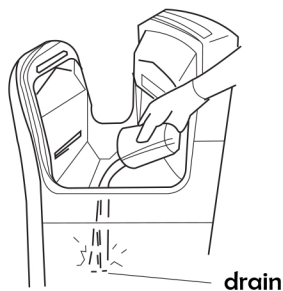

INSTALLATION

Fig. 2

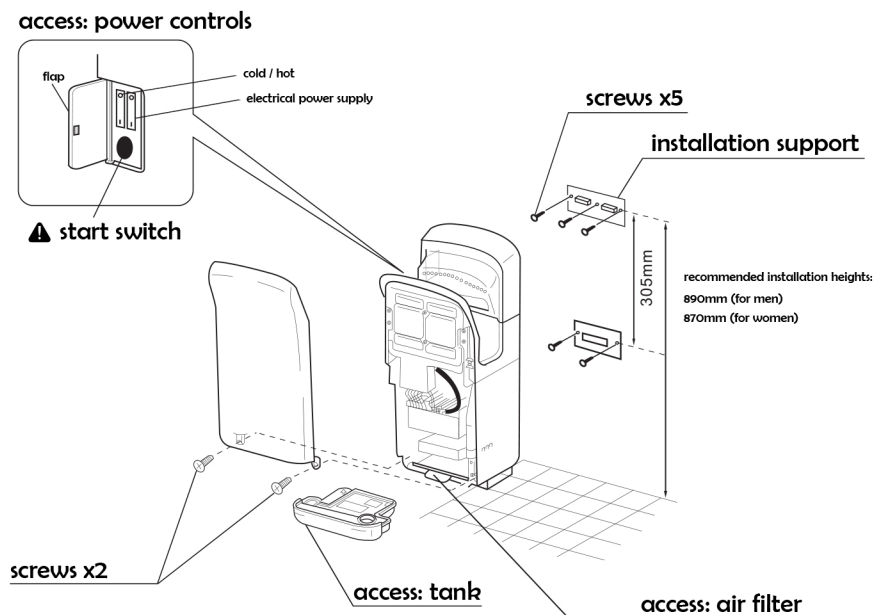

TECHNICAL DATA

VOLTAGE	220-240V / 50-60HZ
RATED POWER	2000W
SENSOR RANGE	120-150MM
WIND SPEED	100M/S
DRYING TIME	15-20S
DIMENSIONS	W90 X D220 X H685
WATERPROOF PROTECT	IPX4

INSTALLATION

FITTING INSTRUCTIONS

- Slide the junction box into the space provided and connect the cable.
Note: the cable **MUST BE CONNECTED**.

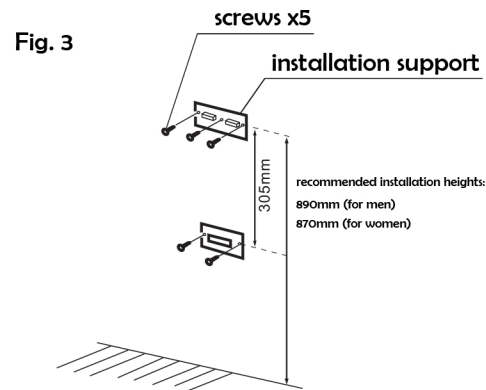

- Secure the support panel onto the wall using the 5 screws provided (use metal dowels if the wall is concrete or reinforce the wall if it is not).

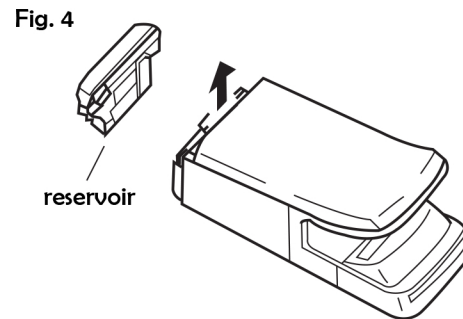

- Remove the tank and the front panel as well as the 2 screws and all clips.

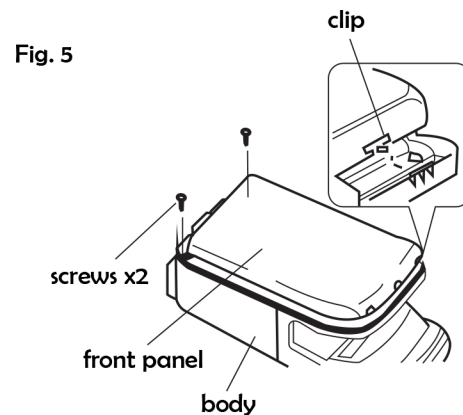

- Feed the power cable through the hole at the back of the unit. Attach the dryer to the 3 hooks of the support panel and secure using 2 screws at the centre and bottom of the appliance. **NOTE:** the unit cannot be installed if the hooks are incorrectly positioned.

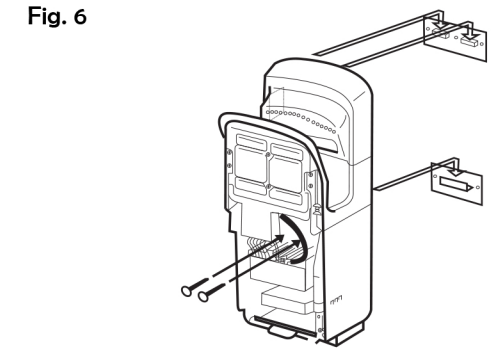

- Detach the cable as shown in fig. 7. Connect the power cable to the terminal block and tighten the screws and cable to securely fix the contacts. Install and tighten the cable clamp.

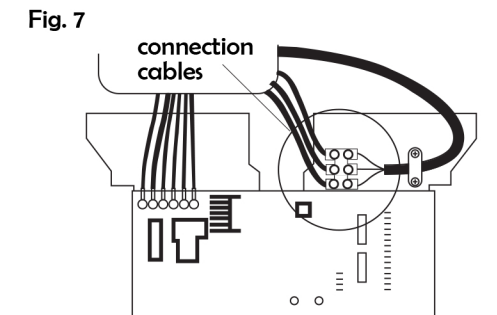

- Replace the front panel using the attached clips to secure to the unit and replace the 2 screws. Replace the tank, ensuring that the air filter is secure and level.

